

Welcome to Fulmar Cottage!



Guest information

Scan the QR code for a soft copy to read on your mobile



<https://www.fulmarcottage.co.uk/private/e0f0d539ca2cff>

www.fulmarcottage.co.uk

Thanks to Joceline Hildrey for the wonderful painting of the nesting Fulmar!

Fulmar Cottage – important information for guests

Welcome to Fulmar Cottage!

We hope you enjoy your stay here at Fulmar on the beautiful Isle of Harris.

We have enclosed within this document useful information about Fulmar Cottage and its appliances to help your enjoyment of Fulmar Cottage. We would be grateful if you could take the time to review this information at the start of your stay, most importantly the fire safety advice.

Table of Contents

- [FIRE SAFETY ADVICE.....](#)3
- [Key safe and keys.....](#)4
- [Parking](#)4
- [Wi-Fi](#)5
- [Pets](#)5
- [No smoking policy.....](#)5
- [Kitchen area, appliances and equipment:.....](#)6
- [Television - streaming, live broadcast channels and blu-ray player.....](#)8
- [Hot water](#)9
- [Heating in the kitchen/living space](#)10
- [Heating in the bedrooms](#)13
- [Linen and towels](#)14
- [Bathrooms and toilets](#)14
- [Washing and drying](#)15
- [Iron and hairdryer.....](#)15
- [Travel cot and highchair](#)15
- [Ventilation](#)15
- [Fuses and fuse box.....](#)15
- [Bins and recycling.....](#)16
- [Things to do and our recommendations](#)17
- [*****EMERGENCY CONTACT DETAILS*****](#)18
- [Day of departure/check out information](#)19
- [Soft copy of user manuals for appliances](#)20

FIRE SAFETY ADVICE

STRICTLY NO SMOKING AND NO CANDLES

Upon your arrival:

- ✓ We suggest you take a photo of this advice for quick reference during your stay.
- ✓ Get to know the property and familiarise yourself with all possible escape routes and exits (including the windows).
- ✓ Establish where the fire extinguishers, fire blankets and emergency torches are located and check instructions for use:
 - A fire blanket is on the wall next to the kitchen sink
 - A small fire extinguisher is on the window cill, next to the kitchen sink above the bin area
 - A larger fire extinguisher is located in the hallway next to the toilet/cloak room door
 - There are emergency torches in the hallway below the dyson Hoover and in the living space next to the door. These torches will also activate in the event of a power cut
- ✓ Discuss how you will evacuate the property with your party and agree an assembly point which should be away from the property. Make sure you make any arrangements for vulnerable adults and children.
- ✓ Keep all window keys in the window locks for a quick exit if required. The front door to the property has a thumb turn lock so does not need a key to be unlocked from the inside.
- ✓ The smoke alarms and carbon monoxide alarms are checked regularly, but we suggest that you test them by pressing the test button using the broom handle that is located in the hallway
- ✓ Please contact the Owners if new batteries are needed for your smoke or carbon monoxide detectors during your stay (you will hear a re-occurring slow beep if this is the case).

Avoid unnecessary risks:

- ✓ Please take care when cooking, especially if deep frying. Do not fill the pan with more than a third of oil and leave to cool if it starts to smoke.
- ✓ Never leave saucepans on the stove/hobs unattended.
- ✓ No matches should be kept on the property as the gas fire and hobs will ignite automatically using the controller/knobs
- ✓ Make sure all portable heaters are positioned away from potentially flammable materials, i.e. sofas, curtains, bedding, clothing, towels
- ✓ All heat sources should be turned off when rooms or the property are left unoccupied
- ✓ Ensure flammable materials are not positioned too close to the gas stove or wall heaters in the bedrooms
- ✓ Candles must not be used in the property

IN THE EVENT OF A FIRE

- ✓ Keep calm
- ✓ Get everyone out of the property as quickly as possible using the nearest exit – either the front door or through the windows
- ✓ **DO NOT** waste time retrieving valuables
- ✓ Close all doors behind you
- ✓ If possible, tackle the fire using the appliances provided, but do not endanger yourself or others by doing so. The safety of your party is the main priority in such a situation
- ✓ Check all members of your party are safe at the agreed assembly point.
- ✓ Dial 999 to call the fire service. Quote the property postcode: HS3 3JA, name: Fulmar Cottage and What 3 Words: *watchdogs.rescue.factoring*. Call the property owner on 07801 069 084 once your party has safely exited the property
- ✓ Do not re-enter the building unless authorised to do so

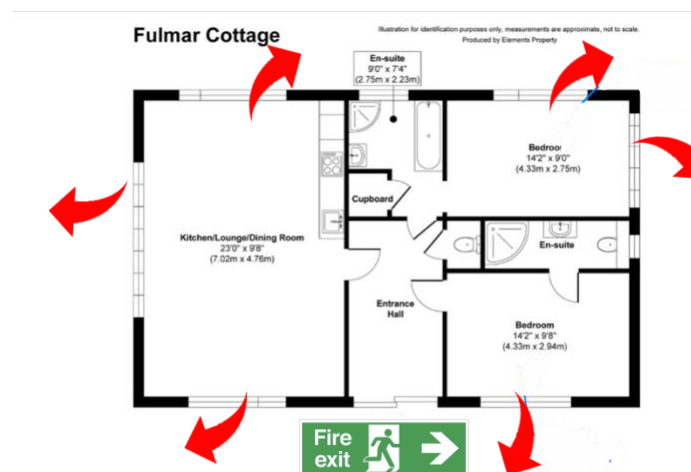

Windows open out wide, release the catch, so that individuals can climb out

Flooring in living space

We are aware that the floorboards in the living space are little wobbly and squeaky in some places, particularly around the kitchen area so please do take take in these areas whilst we arrange to get these fixed and de-squeaked.

Key safe and keys

The key safe is on the wall to the left of the front door to the Cottage. The combination is **8915**. Please lock the front door and return the front door key to the key safe when you leave the Cottage at the end of your stay. We recommend you keep the key in the key safe whilst out of the Cottage exploring the island. The windows all have keys in them, please do not remove these keys and keep the windows unlocked at all times

Parking

The parking area is behind the Cottage and should be able to comfortably accommodate two vehicles. Please do not park by the side of the Cottage as the track is needed for access by our neighbours at Gannet Cottage, it should however be fine to briefly park there for the purposes of unpacking or packing your car upon your arrival/departure.

Wi-Fi

Wi-Fi is provided by the Smart-4G-Hub-9NMR, password details as per enclosed copy of card. You can also scan the below QR code to join the network.

This card is also located by the smart hub which is a white box located on the dresser shelf, to right of the front window in the living space.

We recommend you restart the Smart Hub on arrival, there is an on/off switch at the back of the hub, press and hold this down for a couple of seconds until the lights on the front of the router flash.

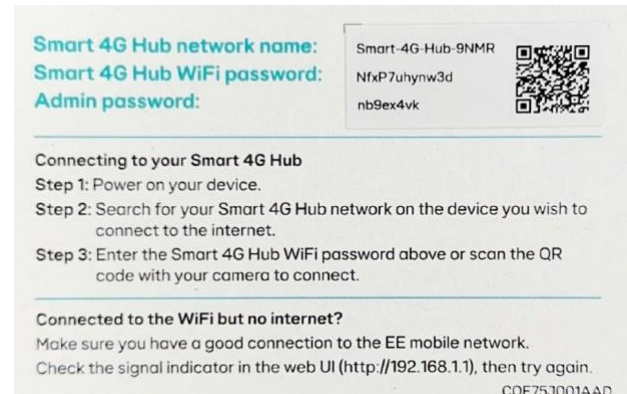

Smart 4G Hub network name: Smart-4G-Hub-9NMR
Smart 4G Hub WiFi password: NfxP7uhynw3d
Admin password: nb9ex4vk

Connecting to your Smart 4G Hub
Step 1: Power on your device.
Step 2: Search for your Smart 4G Hub network on the device you wish to connect to the internet.
Step 3: Enter the Smart 4G Hub WiFi password above or scan the QR code with your camera to connect.

Connected to the WiFi but no internet?
Make sure you have a good connection to the EE mobile network.
Check the signal indicator in the web UI (<http://192.168.1.1>), then try again.

COF75J001AAD

Pets

We are happy to accept dogs at Fulmar Cottage, but we would really appreciate it if you would ensure that your pet stays out of the bedrooms and bathrooms and keeps off the furniture in the living space. Most importantly please pick up, bag and dispose of any dog poo in the bins! We have a lot of families with young children staying in the Cottage (including our own two little ones) who enjoy playing in the grounds around the Cottage.

Dogs must not be left unattended in Fulmar Cottage. When in the grounds outside the Cottage, dogs must always be properly controlled and supervised, ideally on a lead as the grounds are not enclosed or fully secured by a fence.

Please note that when in residence, the owners of Gannet Cottage (which is next to Fulmar Cottage) and Croft 13 at the bottom of the track leading up to Fulmar Cottage, both have dogs.

Please adhere to the canine countryside code when out walking your dogs in areas where livestock are present and follow any requests you may see on signage placed by landowners on your walks.

No smoking policy

Sorry, smoking is not permitted in our Cottage. Should it be found that someone has been smoking within the Cottage, then charges will be made for a 'deep clean'. Please remove any cigarette litter from outside areas before you leave.

Kitchen area, appliances and equipment:

Kitchen appliances

The kitchen area is equipped with a gas hob, microwave, dishwasher, fan oven, kettle, toaster, bean top coffee machine and under the counter fridge. Should extra fridge space be needed, or a freezer compartment, then the fridge freezer in the hallway is also available.

The kitchen appliances, have switches on the wall above the worktop. Please ensure these are switched on, they are worth checking if something doesn't appear to be working. See below photo and text to the right for details of switch locations



- The switch to the right of this switch array powers the microwave.
- The switch to the left of this array powers the fan oven.







The under unit lighting in the kitchen area can be switched on using the light switch array to the right of the living space door by the sofa (third switch along).

Gas hobs, oven and microwave: The kitchen hob is gas powered and will ignite automatically provided the above switch is turned on.

The fan oven is electric, please note should there be a power cut, then the oven clock will blink and the oven will not heat until the clock is reset. If the oven does not appear to be heating and the clock is blinking then please follow the below instructions to reset the clock:

Setting the time

When first connected to the power supply, the digital display will flash **0.00**. The oven will not operate until the time is set.

- Simultaneously touch  and  until you see the dot below the  symbol flashing
- Touch  or  within 7 seconds to set the current time. Once the desired time is set, allow 7 seconds for the dot to stop flashing followed by a beep. The time can be adjusted again at any time by pressing  and  simultaneously and following the same steps

A key explaining the various heating mode symbols on the right-hand side dial for the oven is included at the back of this information booklet.

Microwave, to operate the microwave:

- Press the “Microwave” button once and the display will show “P100”
- Turn the “Multi-Function” knob in either direction to set the power level, this can be set at 100% (700W), 80%, 50%, 30% or 10% of full power (which is 700W); the display will show “P100”, “P80”, “P50”, “P30” or “P10” respectively.
- Press the “Start/+30 Sec./Confirm” button to confirm the power level.
- Turn the “Multi-Function” knob in either direction to set the cooking time. This can be set between 00:05 and 95:00 minutes.
- Press the “Start/+30Sec./Confirm” button again to start cooking

Please avoid placing any metal utensils or trays inside and take care when removing hot items from the microwave.

Please clean the inside of the fan oven and microwave prior to departure.

Worktops, please do not place hot pots, pans or trays on the kitchen worktops to avoid damaging them. Glass worktop savers and chopping boards are provided for use with hot items and when chopping fruit and vegetables, the colourful workshops savers are from the Hope Blamire shop in Tarbet which also sells Hebridean inspired pottery as well as artworks.

Pots, pans, oven trays can be found with the two drawers in the row of kitchen units.

Kitchen utensils, chopping knives and accessories can be found within “the drawer within a drawer” (inside the top drawer of pots and pans you will see a grey draw containing these utensils)

Cutlery, crockery and glassware can be found with the drawers of the dresser in the front right corner of the living area. If not left out on the table already, then place mats can also be found in the top dresser drawers (all designed by Joceline!)

Dishwasher can be found next to the sink and is simple to operate and the setting/programme no. 4 (50 minutes) usually achieves good results. Press the ‘on/off’ button and then press the programme button until the programme no. 4 light is lit. When you close the door, the dishwasher will start automatically. If the salt or rinse aid lights illuminate, then you can find supplies of salt and rinse aid under the sink.

A bean to coffee machine can be found on the small table next to the window and corner dresser unit. Please only use coffee beans in the machine. The machine once turned on will display instructions for you to follow to assist you in making your cup of coffee. The coffee machine includes a milk carafe so you can also make latte’s and flat whites to your liking! The milk carafe can be kept in the fridge if it still contains milk after your coffee, it is also dishwasher safe for cleaning. Please clean and empty the coffee machine of ground coffee bean waste before your departure.

Instruction booklets for any of the appliances can be found within the bottom right drawer of the dresser in a black folder should these be needed for reference.

Television - streaming, live broadcast channels and blu-ray player

All remote controls for the SMART TV, Free Sat receiver and Blu-ray player can be found stored in the remote-control holder on the shelf next to the corner sofa.

The television is a SMART TV connected to the WiFi. The TV is loaded with all streaming apps, including the non-subscription apps of iPlayer, ITVX, All Four and Channel 5, which should be all free to use for UK resident guests. If you have subscriptions to Netflix, Amazon, NowTV, Paramount and Disney+ then these apps are all downloaded for you to use with your account. Please log out of these apps before your departure.

The **SMART Sony TV remote control** for streaming apps is picture opposite and can be found in the remote control holder on the wall above the shelf next to the sofa.

The 'power on/off' button is circled top right.

The 'home' button is circled middle of the control which will take you to the home page where all the streaming apps can be accessed.



The **live broadcast TV channels** are accessed via the **Free Sat** receiver.

The **remote control** for the **Free Sat** receiver is pictured opposite:

If the SMART TV is not already switched on, press the **black 'TV power on/off' button (circled top left) to turn on the TV.**

Then turn on the Free Sat receiver box by pressing the **red power 'on/off' button (circled top centre).**

Note it does take time for the Free Sat receiver to load up, but when it does you will see a TV schedule and can use the remote to select your desired channel(s).



There are number of DVDs within the media unit cupboards that you are welcome to watch.

Hot water

Hot water is provided by an electric immersion heater in the loft, the tank is timed to run 6am – 8am and 6pm – 8pm, this should ensure ample hot water for your use, if this proves insufficient then the boost function can be used via the control panel next to the front door (on the right as you walk into the Cottage). See photo below



Press the large button in the middle of the panel once to boost the hot water tank for 30 mins.

The switch below should be switch on and the red light illuminated as shown.

Heating in the kitchen/living space

Air-to air wall heater

The **primary source of heating for this room** is the air-to-air wall heater in the living space (the large white rectangular box above the Scarista wave mural by the sofa).

The wall heater is pre-programmed to turn on between 6:30 – 8:30 and 19:30 – 22:00 to heat the living space.

To operate the wall heater outside of these times or to adjust the temperature/turn-off the wall heater during the pre-programmed times, please follow the below instructions.

The wall heater is operated using the white thermostat, which can be found on the wall to the right of the gas fire in the left corner of the living space.

1. To **turn the wall heater on**, press on the thermostat in the middle with your finger above the black line, as shown in the below photo:
2. The thermostats display will then activate and show the current room temperature, as shown in the below example:



3. The thermostat will then display a house icon with the text "OFF" as shown in the photo below. To turn the heating ON, press the UP ARROW once
4. The thermostat will then first display the word "HEAT" followed by a hand icon next to the default starting temperature of 18 degrees celsius. As shown below



The wall heater will beep to confirm receipt of the instruction to turn the wall heater on and you will see the flap on the wall heater will open.

Please note: the wall heater takes a couple of minutes to start emitting hot air once activated so please be patient whilst it is starting up. So long as you hear a beep once activating the wall heater then you know the heating instructions have been received.

Adjusting the temperature once the wall heater is operating: just press the thermostat again with your finger (in the same position as when you first turned the wall heater on) and then press the **UP ARROW** (circled in red) to **INCREASE the temperature** or the **DOWN ARROW** (circled in blue) to **DECREASE the temperature**.

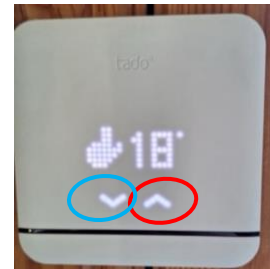

The wall heater will again beep to confirm the instruction to adjust the heating temperature has been received.

To turn the wall heater OFF:

1. Press the thermostat with your finger (in the same area as pressed before) as per below photo
2. Then when the display illuminates press the DOWN ARROW to DECREASE the temperature, **when the display reaches 18C, press the DOWN ARROW one more time only** and the thermostat will display a house logo with the text "OFF", as shown below



The wall heater will then beep, and the flap will close. It may take a couple of minutes before the wall heater powers down and the flap closes, so don't worry if the wall heater does not stop immediately.

Please note:

- Once the room temperature has reached the selected temperature, the wall heater will pause its heating operation, but the flap will remain open, heating will resume when the thermostat detects that the temperature has fallen below the set temperature.
- The thermostat will detect any sudden drop in temperature due to an open window or door causing any heating operation in progress to pause momentarily until the window/door is closed. It will take a couple of minutes for the wall heater to start emitting hot air again.

If you inadvertently, press the down arrow when first switching on the heating then you will set the wall heater to **cooling mode, which is not to be used**. To turn the wall heater back to heat mode, simply keep pressing the up arrow until you see the thermostat displays the word 'HEAT'

Please ensure the heater is switched off before you go to bed or when leaving the Cottage.

Gas fire

The **gas fire** in the left front corner of the living space, should be used as an alternative source of heat in the evenings, if needed, and helps add to the coziness of the Cottage after a long day exploring the surrounds of Harris.

The gas fire is controlled by a remote control, which can be found in a remote-control holder on the wall to the left of the gas fire.

See below photo of the gas fire remote control and instructions:

To ignite the gas fire, point the remote control at the gas fire and simultaneously press the two buttons circled in red in the opposite picture:

You will hear a beep emit from the gas fire after pressing the two buttons which will confirm the gas fire has received the the remote control signal.

Please wait for up to 1 minute after turning the fire on for the pilot light in the back left corner of the fire to light and ignite the flames.



The temperature of the gas fire is controlled by adjusting the height of the flames using the remote control. To **increase the temperature**, press the **top right button** on the remote control (with the large flame symbol next to it). To **decrease the temperature**, press the **bottom left button** (with the small flame symbol next to it).

If you **hear a beep** after pressing the **large flame button**, then you will have **reached the highest temperature**.

If you do set the fire to the highest temperature, **please only use this setting for first 30 mins and then reduce the temperature** as the room will heat up quickly and the highest temperature setting will more quickly use up the gas supply.

To **turn the fire off** simply point the remote at the gas fire and press the “off” button on the bottom left (button with a red dot). You will hear a beep emit from the gas fire to confirm the instruction has been received from the remote control, the flames will then extinguish and the pilot flame in the back right corner will also extinguish.

If you hear a **beep after pressing the small flame button** then you will have **reached lowest temperature setting**, if you press the small flame button again then you will set the fire into pilot light mode. **Please do not leave the pilot mode on but instead switch the fire off.**

Please turn the gas fire off before going to bed or when you are not in the Cottage.

Please do not have both the wall heater and the gas fire on at the same time as the room will heat up very quickly it is also energy inefficient.

Gas bottles

The gas hobs and gas fire are supplied by LPG bottles around the side of the Cottage.

There are two bottles, one bottle is in use and one spare bottle, for when the “in use” bottle runs out.

If the gas supply should run out during your stay, then please turn the black switch (see circled area in opposite photo) so that it points to the opposite bottle to that which it was first pointing too.

Then ensure the valve on the top of the bottle (bronze/gold in colour) is turned to the open position (should be clockwise turn). Please also close the same valve on the empty bottle.

Please can you let the owner or Joceline know if you do switch bottles during your stay, so we know to arrange a replacement to ensure there is always a spare ready to use for future guests.



Heating in the bedrooms

The two bedrooms each have electric wall heaters, which are pre-programmed to heat 5:00AM – 7:00AM in the morning and 7:00PM – 10:00PM in the evenings.

To manually operate the heater outside the pre-programmed times, press the “on/off” button shown opposite and use the up/down arrows to set the desired temperatures.

Please ensure the radiators are turned off, by using the “on/off” button during the day and when you are out of the Cottage.

We are aware that the heater in the main double bedroom is not as effective as we’d hoped due to nature of the room, but it does provide additional warmth which can be further helped by closing the black-out blinds and curtains to keep heat from escaping.

If additional warmth is needed then both bedrooms have electric blankets which are ideal for warming the bed up in early spring and early autumn, only use the electric blankets before you get into bed, **it is important that the blankets are turned off before getting into the bed and turned off whilst you are sleeping and whilst you are away from the Cottage.** The controller switch has a timed option which automatically switches off after a set period of 75 minutes.

Each bedroom also has a small portable electric heater for use, please do not leave these on over night whilst you are sleeping or when you are away from the Cottage and keep positioned away from potentially flammable materials.

Please do not use the white dials that are on the wall in both bedrooms, these dials used to control the underfloor heating, but this has long since given up the ghost so unfortunately no longer works.

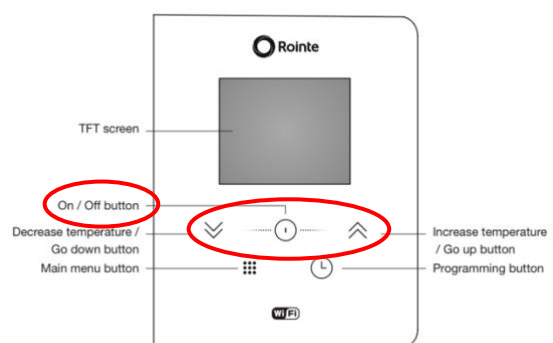

Linen and towels

Linen and towels are provided, and your beds will be made up and the towels laid out for you, as well as a hand towel in each bathroom and drying up towels and a hand towel and oven gloves in the kitchen. We do not provide beach towels.

Bathrooms and toilets

Toilets, please ensure only toilet paper is flushed down the toilet, wet wipes, kitchen towel and other sanitary products should not be flushed down the toilet as they will cause a blockage, please dispose of these responsibly using the waste bins provided.

Heated towel rails in the bathroom and en-suite are operated as follows:

The heated towel rail is best used in 'Max Powr mode, which is operated as follows -

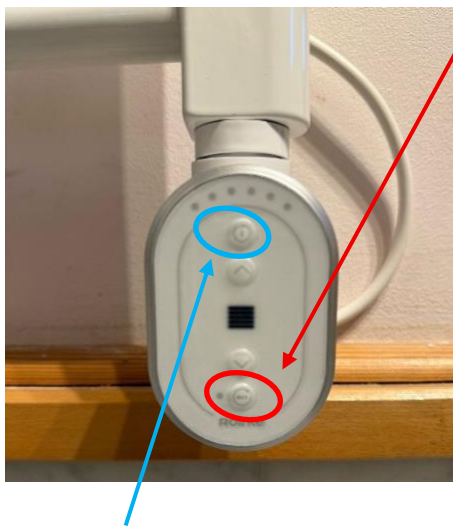

Press the 'Max' button once to switch on the towel rail which will activate the max heating mode for 15 mins, press the Max button again for 30 mins, a further time for 45 mins and so on up to a maximum of 7 times for up to 120 mins.

The LED lights will blink to denote how many times the Max button has been pressed (e.g. first LED light blinking = 15 mins, first two LED lights blinking = 30 mins), the number of lights blinking will then reduce as each 15 min period of time expires.

To **switch the towel rail off** press the "on/off" button as denoted by the blue coloured circle

Please ensure the towel rails switched off during the day when you are out of the Cottage and do not leave on overnight.

Before using the towel rail in the ensuite please ensure the electrical pull chord above the towel rail is activated (the red light should be on).

Similarly in the bathroom the pull chord above the towel rail is displaying a red light and also the white switch on the wall behind the towel rail. These switches are usually left on permanently, but previous guests may have inadvertently switched them off.

Bathroom mirror/cabinet in the main bathroom has a shaver and toothbrush charger power point inside the cabinet to the top right. The mirror illuminates if you wave your hand under the bottom right of the cabinet (ensure the pull chord above the mirror is activated with the red light illuminated). To turn the light off just wave your hand again in the same place under the mirror.

Washing and drying

There is a washer/dryer available for use in the hallway. The washer dryer works best with liquitabs that are placed into the drum with the laundry to be washed. The fabric conditioner goes into middle compartment of the dispenser drawer. We usually wash everything on the standard mixed load wash setting.

The dryer function is adequate, but the hottest setting (intensive dry) does get very hot and could damage delicate clothing. Do treat it with caution when deciding which clothes to dry using the dryer function.

There is a rotary clothesline available for use in grass area between the parking space and the first blue chicken shed, there is a bag of clothes pegs in the cupboard next to the fridge freezer in the hallway. In addition, there is a clothes airer stored underneath the bed on the left in the twin bedroom for use, which has the option to be heated. Please do not leave this turned on overnight or whilst away from the Cottage.

For wetsuits, please use outside tap at the back of the Cottage to wash these and dry them using the outside racks next to the rotary clothes line.

Iron and hairdryer

An iron can be found on the shelf above the wardrobe in the main bedroom and an ironing board to the far side of the wardrobe near the window. Please take care when using the iron and ensure the iron is switched off when you have finished using it. A hairdryer can also be found on the shelf above the wardrobe.

Travel cot and highchair

A travel cot can be found underneath the double bed in the main bedroom, please follow the instructions for assembly. Linen for the cot is not provided. A high chair can be found underneath the single bed on your left as you walk into the twin bedroom, instructions for assembly and use is within the instruction book folder in the dresser, please ensure you follow these and do not leave your child unattended in the high chair.

Ventilation

All the windows have trickle vents to allow fresh air circulation please keep these open in at least one window in each room to allow for this.

Fuses and fuse box

The fuse box is inside the cupboard to the right of the front door as you walk in the Cottage. Within the fuse box is a row of switch-type fuses, so it should be obvious which one has tripped but it doesn't happen that often.

Bins and recycling

Please use the rubbish and recycling wheelie bins for your waste, these can be found at the end of the track down from Fulmar Cottage by the road through Northton, the bins will be on your right-hand side, outside of the metal gates next to the road. Note that the bins inside the metal gate are for the sole use of Croft 13. There are separate bins for general rubbish, food waste, glass bottles/jars and paper/cardboard/plastic containers which are marked on each bin. **Note that not all bin types have the same colouring (which is confusing!), so please double check the labels before putting items into each bin.** When emptying your rubbish/recycling into these bins please keep the area neat and tidy.

Below is the picture of the bin location is provided for reference:



Things to do and our recommendations

The folder of information within the Cottage contains information and ideas about places to visit and eat which might be useful.

The dresser shelf has a number of guidebooks for reference too. You are welcome to take these out with you when touring the islands for ease of reference, but please ensure they are returned to the Cottage at the end of your stay.

The website for Fulmar Cottage has a section entitled 'Things to do', which might also be a useful source of reference for activities, sights, cafes and food shops for your stay, scan the below QR code or go to the below web address for further details:



Things to Do | Fulmar Cottage
www.fulmarcottage.co.uk

<https://www.fulmarcottage.co.uk/things-to-do/>

Our favourite beach: There are so many beautiful beaches to choose from but we love the beaches at Northon on the Cottage's doorstep (they are also easy to get to with our two little children in tow), they love to build sandcastles and play in the sand. When the weather is good, we like to take a picnic with us and walk along the machair to the beach by the temple.

Our favourite places to eat: Croft 36 is great for bakes and pizza, the vegetarian curried pasty is a must! We like the café at Talla Ma Nara which also has a toy box to keep our little ones entertained whilst we enjoy a coffee and piece of cake. The brewery in Leversburgh has a good food menu, often serving local specialities and fish. As you might expect from a brewery, it also has a great selection of beers, both bottled and on tap (they do takeaways too). Skoon Café and art gallery is also a lovely place to visit whilst exploring the golden road and the route via Rodel will take you past the seal colony at Finsbay, the cream scones at Skoon are a must too!

Our favourite places to walk: As well as the Northon beaches we also love to explore the woodland walks around Lews Castle in Stornoway, which also houses a museum and cafe where you can learn more about the heritage of the islands and islanders. The Woodland Café in the grounds of Lews Castle is good place to start or end your walk, it also has a play area outside to keep the little ones entertained.

Closest shop: the Clachan Community shop in Leversburgh is good for everyday groceries and essentials, it also sells petrol/diesel (available 24 hours). There is also Deli at the Brewery in Leversburgh that is worth a visit, as is the Deli in Tarbert which also has a small grocery shop. Further afield there is a larger Co-Op and Tesco in Stornoway which do click and collect and home delivery down to Fulmar Cottage (but slots are limited and are quickly taken). Croft 36 down the track from the Cottage is great for freshly baked products, soup and pizza at the weekends (it is an honesty shed so its just cash or PayPal).

*******EMERGENCY CONTACT DETAILS*******

In the case of an emergency of if you need assistance during your stay please contact either Joceline, who is on the island, on 07801 812 261 or the owner (Steve Worrall) on 07801 069 084 or stay@fulmarcottage.co.uk

In the event of a medical emergency or fire please call 999 immediately

Day of departure/check out information

Check out time is by **10am** on the Friday or day of your departure.

Before you leave!

Just a bit of official stuff to be aware of before you leave. Thankfully, we almost never have to charge any of our guests because you are all so lovely; but the Cottage must be left clean and tidy, and all the equipment and utensils etc; must be clean and put away at the end of your rental period. Should the property be found to require significant extra cleaning because of the condition in which it is left then these additional costs will be sought from yourself. Sorry for the reminder, and we hope you will treat Fulmar Cottage kindly and enjoy your time in its beautiful surroundings.

To assist Joceline, who will be carrying out the changeover activities and preparing the Cottage for the next guests, please can departing guests:

- Strip all used bed linen and place sheets, duvet covers and pillowcases (not mattress protectors) in the bath in the main bathroom.
- Similarly place all used towels, bathmats and tea towels also in the bath
- Please empty the dishwasher and ensure all used cutlery and crockery has been washed, dried and put away where you found it
- Please dispose of any leftover food from the fridge and freezer
- Please empty all bins and take to the appropriate bins at the bottom of the track next to Croft 13
- Please ensure all windows are closed and the front door key returned to the key safe box

Thank you, we hope you enjoyed your stay and have a safe journey home!

We are pleased to offer all returning guests a 10% discount on future stays at Fulmar Cottage. Please contact us for further details.

Soft copy of user manuals for appliances

Oven:



https://www.fulmarcottage.co.uk/wp-content/uploads/2026/05/SL300_im-Oven.pdf

www.fulmarcottage.co.uk

https://www.fulmarcottage.co.uk/wp-content/uploads/2026/05/SL300_im-Oven.pdf

Quick reference key to fan oven symbols on right hand side dial

Oven functions and operation

○/● **Oven is off**



Eco heating

This is an optimised heating function designed to save energy. When using this function the oven light is intentionally left off.



Light

The oven light will be turned on.



Fan cooking with lower heat

With this setting the convection fan and bottom heater are on, which increases the temperature at the bottom of the cooked dish. Intense heat from the bottom is ideal for moist cakes and pizza.



Fan assisted oven

This setting is most suitable for baking cakes.



Fan oven

This function uses the circular heating element with a temperature between 50°C and 250°C. The fan then circulates the hot air which helps to achieve uniform heat distribution.



Conventional oven

The thermostat enables the user to set the temperature within a range of 100°C to 250°C. This setting is ideal for baking cakes, meat, fish, bread and pizza. For best results preheat the oven and use a baking tray on one level.

Oven functions and operation



Warming oven

This function radiates heat from the bottom element, baking cakes from underneath until done.



Half grill

This function radiates heat from the grill element. This fully temperature variable grill can be set between 50°C and 250°C maximum.



Full grill

In this setting both the grill and top element are engaged. This increases the temperature in the top part of the oven chamber making it suitable for browning and roasting larger portions of food. It can be set between 50°C and 250°C maximum.



Fanned full grill

This function radiates heat from the grill element and the top element but also uses the fan to circulate hot air. The hot air is distributed over and under the food that you are grilling. This fully temperature variable grill is ideal for grilling fish or other items where the appearance could be spoiled by a normal grill function. It can be set between 50°C and 190°C maximum.



Defrost

This function uses the fan to circulate air at ambient temperature within the oven which helps to accelerate the defrosting process.



Rapid preheating

Use to preheat the oven.

Using the grill

Important!

When using any grill function the oven door should be kept closed. When the grill is in use accessible parts can become hot, it is advisable to keep children away from the oven.

In order to switch on the grill you need to:

- Set the function selector knob to the desired grill setting
- Heat the oven for approximately 5 minutes with the oven door shut
- Insert a tray on to the appropriate cooking level; if you are grilling food directly on the wire shelf, place a tray on the level immediately below
- Close the oven door

When using the half grill or full grill functions the maximum temperature that can be set is 250°C. The maximum the fanned grill can be set to is 190°C.

Dishwasher:



https://www.fulmarcottage.co.uk/wp-content/uploads/2026/05/Dishwasher-GPID_1101253212_TECH_00.pdf

www.fulmarcottage.co.uk

https://www.fulmarcottage.co.uk/wp-content/uploads/2026/05/Dishwasher-GPID_1101253212_TECH_00.pdf

Microwave:



https://www.fulmarcottage.co.uk/wp-content/uploads/2026/05/Microwave-GPID_1101186041_TECH_00.pdf

www.fulmarcottage.co.uk

https://www.fulmarcottage.co.uk/wp-content/uploads/2026/05/Microwave-GPID_1101186041_TECH_00.pdf

Washer/Dryer:



<https://www.fulmarcottage.co.uk/wp-content/uploads/2026/05/Washer-dryer.pdf>

www.fulmarcottage.co.uk

<https://www.fulmarcottage.co.uk/wp-content/uploads/2026/05/Washer-dryer.pdf>

Heated towel rails:



<https://www.fulmarcottage.co.uk/wp-content/uploads/2026/05/Towel-rails-MPPAMAN451-ELBA-OVAL.pdf>

www.fulmarcottage.co.uk

<https://www.fulmarcottage.co.uk/wp-content/uploads/2026/05/Towel-rails-MPPAMAN451-ELBA-OVAL.pdf>

Gas fire:



<https://www.fulmarcottage.co.uk/wp-content/uploads/2026/05/Gas-Fire-Loft-Conventional-Flue-Installation-Instructions.pdf>

www.fulmarcottage.co.uk

<https://www.fulmarcottage.co.uk/wp-content/uploads/2026/05/Gas-Fire-Loft-Conventional-Flue-Installation-Instructions.pdf>

Printed copies of user manuals can also be found in the black folder in the bottom right drawer of the dresser unit in the living space (next to dining table).